

KUT6

Terminal Type - KUT6 , Feed-through terminal block, nominal voltage: 800 V, nominal current: 41 A, connection method: Screw connection, number of connections: 2, Rated cross section: 6.0 mm² , cross section: 0.5 mm² - 10 mm², AWG: 20 - 8, mounting type: TS35/7.5 , TS35/15 , TS32 and TS15

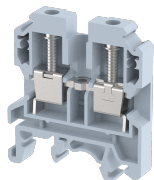

Approvals



General Information

Product Name	KUT6
Connection Method	Screw Connection
Rating	800 V/41 A/6 mm ² /0.8 Nm
HSN Number	8904476702104
Standard Packing Qty(in No)	100
Country Of Origin	India
Screw thread	M3.5

Dimensions & Weight

Width	8 mm	0.31 inch
Length	42.5 mm	1.67 inch
Height	46.4 mm	1.83 inch
Weight of std. Packing Unit	1.45 Kg	

Material Data

Insulating Material	Polyamide 6,6
Standard Colour	Gray
Colour Variants	Red , Yellow , Blue , Black , Green , Khakhi ,

Rated Conductor Size

Conductor cross section flexible min	0.5 mm ²
Conductor cross section flexible max	6 mm ²
Conductor cross section solid min	0.5 mm ²
Conductor cross section solid max	10 mm ²

Ratings - IEC

Connection in acc. with standard	IEC 60947-7-1
Nominal Voltage U_n	800 V
Nominal Current I_n	41 A
Nominal cross section	6 mm ²
Short-time current	0.72 kA
Rated surge voltage	8 kV
Degree of pollution	3

Ratings - ATEX

ATEX Standard	EN60079-7
ATEX Nominal Voltage U_n	630 V
ATEX Nominal Current I_n	41 A
ATEX Cross Sec. Flexible Max.	6 mm ²

Ratings - CSA

CSA Standard	CSA C22.2 NO 158
B - CSA Nominal Voltage U_N	600 V
B - CSA Nominal Current I_N	50 A
B - CSA Wire Min	20 AWG
B - CSA Wire Max	8 AWG

Ratings - UL

UL Standard	UL 1059
B - UL Nominal Voltage U_N	600 V
B - UL Nominal Current I_N	50 A
B - UL Wire Min	20 AWG
B - UL Wire Max	8 AWG