

## KUT25

Terminal Type - KUT25 , Feed-through terminal block, nominal voltage: 1000 V, nominal current: 101 A, connection method: Screw connection, number of connections: 2, Rated cross section: 25 mm<sup>2</sup>, cross section: 6 mm<sup>2</sup> - 25 mm<sup>2</sup>, AWG: 2-10, mounting type: TS 35/7.5 , TS 35/15 , and TS 32

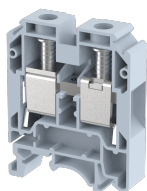

### Approvals



### General Information

Product Name	KUT25
Connection Method	Screw Connection
Rating	1000 V/101 A/25 mm <sup>2</sup> /2.3 Nm
HSN Number	8904476702135
Standard Packing Qty(in No)	50
Country Of Origin	India
Screw thread	M5

### Dimensions & Weight

Width	12 mm	0.47 inch
Length	45 mm	1.77 inch
Height	56 mm	2.2 inch
Weight of std. Packing Unit	1.84 Kg	

### Material Data

Insulating Material	Polyamide 6,6
Standard Colour	Gray
Colour Variants	Red , Yellow , Blue , Black , Green , Khakhi ,

### Rated Conductor Size

Conductor cross section flexible min	6 mm <sup>2</sup>
Conductor cross section flexible max	25 mm <sup>2</sup>
Conductor cross section solid min	6 mm <sup>2</sup>
Conductor cross section solid max	25 mm <sup>2</sup>

### Ratings - IEC

Connection in acc. with standard	IEC 60947-7-1
Nominal Voltage $U_n$	1000 V
Nominal Current $I_n$	101 A
Nominal cross section	25 mm <sup>2</sup>
Short-time current	3 kA
Rated surge voltage	8 kV
Degree of pollution	3

### Ratings - ATEX

ATEX Standard	EN-60079-7
ATEX Nominal Voltage $U_n$	630 V
ATEX Nominal Current $I_n$	101 A
ATEX Cross Sec. Flexible Max.	16 mm <sup>2</sup>

### Ratings - CSA

CSA Standard	CSA C22.2 NO 158
B - CSA Nominal Voltage $U_N$	600 V
B - CSA Nominal Current $I_N$	115 A
B - CSA Wire Min	10 AWG
B - CSA Wire Max	2 AWG

### Ratings - UL

UL Standard	UL 1059
B - UL Nominal Voltage $U_N$	600 V
B - UL Nominal Current $I_N$	115 A
B - UL Wire Min	10 AWG
B - UL Wire Max	2 AWG