

SQM2.5

Terminal Type - SQM2.5 , Mini and Micro feed through terminal block, nominal voltage: 1000 V, nominal current: 24 A, Rated cross-section: 2.5 mm², connection method: Spring Cage connection, number of connections: 2, cross-section: 0.08 mm² - 4 mm², AWG : 24-12 , mounting type: TS 15

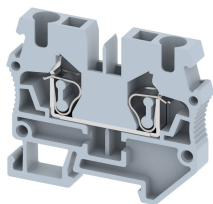

Approvals



General Information

Product Name	SQM2.5
Connection Method	Spring Cage Connection
Rating	1000 V / 24 A / 2.5 mm ² / Nm
HSN Number	85389000
Standard Packing Qty (in No)	100
Country Of Origin	India
Screw thread	-

Dimensions & Weight

Width	5 mm	0.2 inch
Length	39.8 mm	1.57 inch
Height	32.7 mm	1.29 inch
Weight of std. Packing Unit	0.53 Kg	

Material Data

Insulating Material	Polyamide 6,6
Standard Colour	Gray
Colour Variants	Red, Yellow, Blue, Black, Green, Khakhi

Rated Conductor Size

Conductor cross section flexible min	0.08 mm ²
Conductor cross section flexible max	2.5 mm ²
Conductor cross section solid min	0.08 mm ²
Conductor cross section solid max	4 mm ²

Rated Conductor Size

Conductor cross section flexible min	0.08 mm ²
Conductor cross section flexible max	2.5 mm ²

Conductor cross section solid min	0.08 mm ²
Conductor cross section solid max	4 mm ²

Ratings - ATEX

ATEX Standard	EN 60049-7
ATEX Nominal Voltage U _n	630 V
ATEX Nominal Current I _n	20 A
ATEX Cross Sec. Flexible Max.	2.5 mm ²

Ratings - CSA







CSA Standard	CSA C22.2 NO 158
B - CSA Nominal Voltage U _N	600 V
B - CSA Nominal Current I _N	20 A
B - CSA Wire Min	24 AWG
B - CSA Wire Max	12 AWG

Ratings - UL

UL Standard	UL 1059
B - UL Nominal Voltage U _N	600 V
B - UL Nominal Current I _N	20 A
B - UL Wire Min	24 AWG
B - UL Wire Max	12 AWG

Product Accessories

DIN Rail Perforated		
CHM	Height : 5.00 mm Width : 15.00 mm Thickness : 1.00 mm	
End Clamp		
SCMN	Height : 18.00 mm Width : 6.10 mm Length : 23.50 mm	
End Cover		
CSPM2.5	Height : 24.90 mm Width : 2.00 mm Length : 39.80 mm	

Marker For Terminal Blocks		
LABEL KN5	Height : 2.42 mm Width : 5.00 mm Length : 7.50 mm	
Plug-in Bridge/Jumper		
SLPU5-10W	Height : 26.00 mm Width : 3.00 mm Pitch : 5.00 mm Length : 49.15 mm	
SLPU5-2W	Height : 26.00 mm Width : 3.00 mm Pitch : 5.00 mm Length : 9.15 mm	
SLPU5-3W	Height : 26.00 mm Width : 3.00 mm Pitch : 5.00 mm Length : 14.15 mm	
SLPU5-4W	Height : 26.00 mm Width : 3.00 mm Pitch : 5.00 mm Length : 19.15 mm	
SLPU5-5W	Height : 26.00 mm Width : 3.00 mm Pitch : 5.00 mm Length : 24.15 mm	
SLPU5-6W	Height : 26.00 mm Width : 3.00 mm Pitch : 5.00 mm Length : 29.15 mm	
SLPU5-7W	Height : 26.00 mm Width : 3.00 mm Pitch : 5.00 mm Length : 34.15 mm	