

SQECDDWP

Terminal Type - SQECDDWP , PCB Connector Without Stacking pins , nominal voltage: 250 V, nominal current: 15 A, Rated cross section: 2.5 mm², connection method: Spring Cage connection, number of connections: 2, cross section: 0.5 mm² - 2.5 mm², AWG: 24 - 12, mounting type - Printed circuit board (PCB)

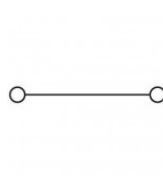

Approvals

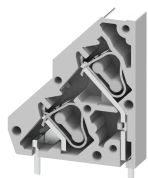

General Information

Product Name	SQECDDWP
Connection Method	Spring Cage Connection
Rating	250 V / 15 A / 2.5 mm ² / Nm
HSN Number	85389000
Standard Packing Qty (in No)	100
Country Of Origin	India
Screw thread	NA

Dimensions & Weight

Width	5.08 mm	0.2 inch
Length	22.1 mm	0.87 inch
Height	25.5 mm	1 inch
Weight of std. Packing Unit	0.35 Kg	

Material Data

Insulating Material	Polyamide 6,6
Standard Colour	Gray
Colour Variants	-

Rated Conductor Size

Conductor cross section flexible min	0.5 mm ²
Conductor cross section flexible max	2.5 mm ²
Conductor cross section solid min	0.5 mm ²
Conductor cross section solid max	2.5 mm ²

Rated Conductor Size

Conductor cross section flexible min	0.5 mm ²
Conductor cross section flexible max	2.5 mm ²

Datasheet

Conductor cross section solid min	0.5 mm ²
Conductor cross section solid max	2.5 mm ²

Product Accessories

End Cover		
SQECDDCP	Height : 25.50 mm Width : 1.00 mm Length : 22.00 mm	

