

## SQECD

Terminal Type - SQECD , PCB Connector , nominal voltage: 250 V, nominal current: 15 A, connection method: Spring Cage connection, number of connections: 1 , cross-section: 0.5 mm<sup>2</sup> - 2.5 mm<sup>2</sup>, AWG: 24 - 12, mounting type - Printed circuit board (PCB)

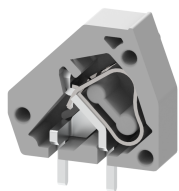

### Approvals



### General Information

Product Name	SQECD
Connection Method	Spring Cage Connection
Rating	250 V / 15 A / 2.5 mm <sup>2</sup> / Nm
HSN Number	85389000
Standard Packing Qty (in No)	100
Country Of Origin	India
Screw thread	NA

### Dimensions & Weight

Width	5.08 mm	0.2 inch
Length	15.4 mm	0.61 inch
Height	14.2 mm	0.56 inch
Weight of std. Packing Unit	0.21 Kg	

### Material Data

Insulating Material	Polyamide 6,6
Standard Colour	Gray
Colour Variants	-

### Rated Conductor Size

Conductor cross section flexible min	0.5 mm <sup>2</sup>
Conductor cross section flexible max	2.5 mm <sup>2</sup>
Conductor cross section solid min	0.5 mm <sup>2</sup>
Conductor cross section solid max	2.5 mm <sup>2</sup>

### Rated Conductor Size

Conductor cross section flexible min	0.5 mm <sup>2</sup>
Conductor cross section flexible max	2.5 mm <sup>2</sup>
Conductor cross section solid min	0.5 mm <sup>2</sup>

Conductor cross section solid max	2.5 mm <sup>2</sup>
-----------------------------------	---------------------

**Product Accessories**

End Cover		
SQECDP	Height : 14.20 mm Width : 1.00 mm Length : 15.40 mm	

