

## OAT6DTS

Terminal Type - OAT6DTS, Test Disconnect Terminal Block, nominal voltage: 1000 V (Tested at 1100 V), nominal current: 41 A, connection method: Bolt connection, number of connections: 2, cross-section: 0.5 mm<sup>2</sup> - 6 mm<sup>2</sup>, mounting type: TS 35/7.5, TS 35/15, TS 32

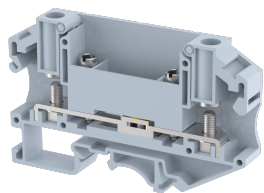

### Approvals

LRCE

### General Information

Product Name	OAT6DTS
Connection Method	Bolt Connection
Rating	1000 V / 41 A / 6 mm <sup>2</sup> / 1.5 Nm
HSN Number	85389000
Standard Packing Qty (in No)	40
Country Of Origin	India
Screw thread	M4

### Dimensions & Weight

Width	11 mm	0.43 inch
Length	83 mm	3.27 inch
Height	51 mm	2.01 inch
Weight of std. Packing Unit	1.6 Kg	

### Material Data

Insulating Material	Polyamide 6,6
Standard Colour	Gray
Colour Variants	Red, Yellow, Blue, Black, Green, Khakhi

### Rated Conductor Size

Conductor cross section flexible min	0.5 mm <sup>2</sup>
Conductor cross section flexible max	6 mm <sup>2</sup>
Conductor cross section solid min	0.5 mm <sup>2</sup>
Conductor cross section solid max	6 mm <sup>2</sup>

### Rated Conductor Size

Conductor cross section flexible min	0.5 mm <sup>2</sup>
Conductor cross section flexible max	6 mm <sup>2</sup>

Conductor cross section solid min	0.5 mm <sup>2</sup>
Conductor cross section solid max	6 mm <sup>2</sup>

**Product Accessories**

**Cover Profile**

PCPDBF-5	Height : 14.10 mm Thickness : 1.50 mm Length : 113.00 mm	
----------	--	---

**DIN Rail Perforated**

CHKDS	Height : 15.00 mm Width : 35.00 mm Thickness : 1.50 mm Length : 2,000.00 mm	
-------	--	---

CHKS	Height : 7.50 mm Width : 35.00 mm Thickness : 1.00 mm	
------	---	---

CHS	Height : 15.00 mm Width : 32.00 mm Thickness : 1.50 mm	
-----	--	--

**DIN Rail, Unperforated**

CHKD	Height : 15.00 mm Width : 35.00 mm Thickness : 1.50 mm	
------	--	---

CHK	Height : 7.50 mm Width : 35.00 mm Thickness : 1.00 mm	
-----	---	---

**End Cap**

CHKENDCAP	Height : 14.00 mm Width : 9.00 mm Length : 41.50 mm	
-----------	---	---



**End Clamp**

SCEC35	Height : 31.50 mm Width : 8.00 mm Length : 45.80 mm	
--------	---	---

SCUP	Height : 34.00 mm Width : 9.00 mm Length : 44.75 mm	
------	---	---

<b>End Clamp</b>		
SCUSL	Height : 41.10 mm Width : 8.00 mm Length : 47.50 mm	
SCUDD	Height : 50.00 mm Width : 10.00 mm Length : 55.60 mm	
DCKN	Height : 33.00 mm Width : 6.00 mm Length : 43.50 mm	
DCKN10	Height : 35.00 mm Width : 10.00 mm Length : 43.50 mm	
SCKN	Height : 34.50 mm Width : 8.00 mm Length : 44.90 mm	
SCUN	Height : 35.50 mm Width : 9.50 mm Length : 50.60 mm	
<b>End Cover</b>		
OEP6DTS	Height : 41.60 mm Width : 2.00 mm Length : 83.00 mm	
<b>Insertion Bridge</b>		
OSL6R-10W	Height : 25.70 mm Pitch : 11.00 mm Length : 107.00 mm	
OSL6R-2W	Height : 25.70 mm Pitch : 11.00 mm Length : 19.00 mm	
OSL6R-3W	Height : 25.70 mm Pitch : 11.00 mm Length : 30.00 mm	
OSL6R-4W	Height : 25.70 mm Pitch : 11.00 mm Length : 41.00 mm	

Insertion Bridge		
OSL6R-5W	Height : 25.70 mm Pitch : 11.00 mm Length : 52.00 mm	
OSL6-10W	Height : 25.50 mm Width : 3.50 mm Pitch : 11.00 mm Length : 107.00 mm	
OSL6-2W	Height : 25.50 mm Width : 3.50 mm Pitch : 11.00 mm Length : 19.00 mm	
OSL6-3W	Height : 25.50 mm Width : 3.50 mm Pitch : 11.00 mm Length : 30.00 mm	
OSL6-4W	Height : 25.50 mm Width : 3.50 mm Pitch : 11.00 mm Length : 41.00 mm	
OSL6-5W	Height : 25.50 mm Width : 3.50 mm Pitch : 11.00 mm Length : 52.00 mm	
OSL6R-6W	Height : 25.70 mm Pitch : 11.00 mm Length : 63.00 mm	
Marker For Terminal Blocks		
LABEL KN 9	Height : 2.00 mm Width : 9.00 mm Length : 6.00 mm	
Partition Plate		
DBF-5	Height : 54.00 mm Width : 3.00 mm Length : 112.00 mm	
Switching Jumper		
OSLD6-2W	Height : 23.70 mm Width : 20.00 mm Pitch : 11.00 mm	

Switching Jumper		
OSLD6-3W	Height : 23.70 mm Width : 31.00 mm Pitch : 11.00 mm	
OSLD6-4W	Height : 23.70 mm Width : 42.00 mm Pitch : 11.00 mm	

Test Adapter / Test Socket		
OAT6DTSTP-Y	Height : 41.00 mm Width : 6.00 mm	
OAT6DTSTP-B	Height : 41.70 mm Width : 6.00 mm	
OAT6DTSTP-BL	Height : 41.70 mm Width : 6.00 mm	
OAT6DTSTP-G	Height : 41.70 mm Width : 6.00 mm	
OAT6DTSTP-GR	Height : 41.70 mm Width : 6.00 mm	
OAT6DTSTP-R	Height : 41.70 mm Width : 6.00 mm	

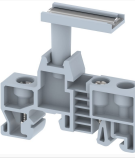
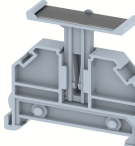
Marker carriers		
SCUDDMLH	Height : 71.50 mm Width : 11.00 mm Length : 55.60 mm	
SCUNMLH	Height : 53.50 mm Width : 11.00 mm Length : 50.60 mm	
DCKNMLH	Height : 45.00 mm Width : 10.00 mm Length : 43.50 mm	

Marker carriers		
SCKNMLH	Height : 42.00 mm Width : 16.00 mm Length : 44.70 mm	
Switching Lock		
OAT6DTSLP	Height : 40.80 mm Thickness : 7.90 mm Length : 21.05 mm	