

## KUT6

Terminal Type - KUT6 , Feed-through terminal block, nominal voltage: 800 V, nominal current: 41 A, connection method: Screw connection, number of connections: 2, Rated cross section: 6.0 mm<sup>2</sup> , cross section: 0.5 mm<sup>2</sup> - 10 mm<sup>2</sup>, AWG: 20 - 8, mounting type: TS35/7.5 , TS35/15 , TS32 and TS15

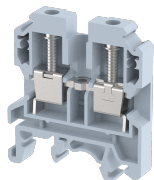

### Approvals



### General Information

Product Name	KUT6
Connection Method	Screw Connection
Rating	800 V / 41 A / 6 mm <sup>2</sup> / 0.8 Nm
HSN Number	8904476702104
Standard Packing Qty (in No)	100
Country Of Origin	India
Screw thread	M3.5

### Dimensions & Weight

Width	8 mm	0.31 inch
Length	42.5 mm	1.67 inch
Height	46.4 mm	1.83 inch
Weight of std. Packing Unit	1.45 Kg	

### Material Data

Insulating Material	Polyamide 6,6
Standard Colour	Gray
Colour Variants	Red, Yellow, Blue, Black, Green, Khakhi

### Rated Conductor Size

Conductor cross section flexible min	0.5 mm <sup>2</sup>
Conductor cross section flexible max	6 mm <sup>2</sup>
Conductor cross section solid min	0.5 mm <sup>2</sup>
Conductor cross section solid max	10 mm <sup>2</sup>

### Rated Conductor Size

Conductor cross section flexible min	0.5 mm <sup>2</sup>
Conductor cross section flexible max	6 mm <sup>2</sup>

Conductor cross section solid min	0.5 mm <sup>2</sup>
Conductor cross section solid max	10 mm <sup>2</sup>

### Ratings - ATEX

ATEX Standard	EN60079-7
ATEX Nominal Voltage U <sub>n</sub>	630 V
ATEX Nominal Current I <sub>n</sub>	41 A
ATEX Cross Sec. Flexible Max.	6 mm <sup>2</sup>

### Ratings - CSA

CSA Standard	CSA C22.2 NO 158
B - CSA Nominal Voltage U <sub>N</sub>	600 V
B - CSA Nominal Current I <sub>N</sub>	50 A
B - CSA Wire Min	20 AWG
B - CSA Wire Max	8 AWG



### Ratings - UL

UL Standard	UL 1059
B - UL Nominal Voltage U <sub>N</sub>	600 V
B - UL Nominal Current I <sub>N</sub>	50 A
B - UL Wire Min	20 AWG
B - UL Wire Max	8 AWG

### Product Accessories

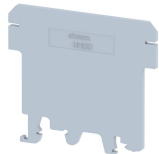
Cover Profile		
PCK3	Height : 28.00 mm Width : 58.35 mm Thickness : 1.00 mm	

Cover Profile Carrier		
UHDD	Height : 74.50 mm Thickness : 2.00 mm Length : 55.82 mm	

DIN Rail Perforated		
CHM	Height : 5.00 mm Width : 15.00 mm Thickness : 1.00 mm	
CHKDS	Height : 15.00 mm Width : 35.00 mm Thickness : 1.50 mm Length : 2,000.00 mm	

<b>DIN Rail Perforated</b>		
CHKS	Height : 7.50 mm Width : 35.00 mm Thickness : 1.00 mm	
CHS	Height : 15.00 mm Width : 32.00 mm Thickness : 1.50 mm	
<b>DIN Rail, Unperforated</b>		
CHKD	Height : 15.00 mm Width : 35.00 mm Thickness : 1.50 mm	
CHK	Height : 7.50 mm Width : 35.00 mm Thickness : 1.00 mm	
<b>End Cap</b>		
CHKENDCAP	Height : 14.00 mm Width : 9.00 mm Length : 41.50 mm	
<b>End Clamp</b>		
SCUP	Height : 34.00 mm Width : 9.00 mm Length : 44.75 mm	
SCEC35	Height : 31.50 mm Width : 8.00 mm Length : 45.80 mm	
SCUSL	Height : 41.10 mm Width : 8.00 mm Length : 47.50 mm	
SCUDD	Height : 50.00 mm Width : 10.00 mm Length : 55.60 mm	
DCKN	Height : 33.00 mm Width : 6.00 mm Length : 43.50 mm	

<b>End Clamp</b>		
DCKN10	Height : 35.00 mm Width : 10.00 mm Length : 43.50 mm	
SCKN	Height : 34.50 mm Width : 8.00 mm Length : 44.90 mm	
SCUN	Height : 35.50 mm Width : 9.50 mm Length : 50.60 mm	
<b>End Cover</b>		
KPX	Height : 36.00 mm Width : 1.50 mm Length : 40.00 mm	
<b>Fixed Bridge</b>		
CCLA6-2W	Height : 24.20 mm Width : 5.50 mm Pitch : 8.00 mm Length : 13.50 mm	
CCLA6-10W	Height : 24.20 mm Width : 5.50 mm Pitch : 8.00 mm Length : 78.10 mm	
CCLA6-3W	Height : 24.20 mm Width : 5.50 mm Pitch : 8.00 mm Length : 21.60 mm	
CCLA6-4W	Height : 24.20 mm Width : 5.50 mm Pitch : 8.00 mm Length : 29.70 mm	
CCLA6-5W	Height : 24.20 mm Width : 5.50 mm Pitch : 8.00 mm Length : 37.70 mm	
CCLA6-6W	Height : 24.20 mm Width : 5.50 mm Pitch : 8.00 mm Length : 45.80 mm	

Insertion Bridge		
SLC6-10W	Height : 26.00 mm Width : 3.00 mm Pitch : 8.00 mm Length : 78.60 mm	
SLC6-3W	Height : 26.00 mm Width : 3.00 mm Pitch : 8.00 mm Length : 22.60 mm	
SLC6-4W	Height : 26.00 mm Width : 3.00 mm Pitch : 8.00 mm Length : 30.60 mm	
SLC6-5W	Height : 26.00 mm Width : 3.00 mm Pitch : 8.00 mm Length : 38.60 mm	
SLC6-6W	Height : 26.00 mm Width : 3.00 mm Pitch : 8.00 mm Length : 46.60 mm	
SLC6-2W	Height : 26.00 mm Width : 3.00 mm Pitch : 8.00 mm Length : 14.60 mm	
Marker For Terminal Blocks		
LABEL KN8	Height : 2.43 mm Width : 8.00 mm Length : 8.50 mm	
Partition Plate		
KBXF	Height : 53.40 mm Width : 1.50 mm Length : 54.00 mm	
KBX	Height : 43.00 mm Width : 1.50 mm Length : 54.00 mm	
Switching Jumper		
LSR2.5-6	Height : 23.00 mm Width : 5.00 mm	

Switching Jumper		
RSL6	Thickness : 1.20 mm Pitch : 8.00 mm Length : 13.80 mm	
Warning Label		
WL6	Height : 28.00 mm Thickness : 1.10 mm Length : 31.00 mm	
Marker carriers		
SCUDDMLH	Height : 71.50 mm Width : 11.00 mm Length : 55.60 mm	
SCUNMLH	Height : 53.50 mm Width : 11.00 mm Length : 50.60 mm	
DCKNMLH	Height : 45.00 mm Width : 10.00 mm Length : 43.50 mm	
SCKNMLH	Height : 42.00 mm Width : 16.00 mm Length : 44.70 mm	