

## KATM5C

Terminal Type - KATM5C , Feed Through Terminal Block with hinged covers, nominal voltage: 800 V, nominal current: 76 A, connection method: Bolt connection - Screw driver Operated, number of connections: 2, Rated cross section: 16 mm<sup>2</sup> , cross section: 0.5 mm<sup>2</sup> - 16 mm<sup>2</sup>, AWG: 14-6 , mounting type: TS 35/7.5, TS 35/15 , TS 32

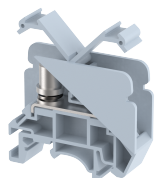

### Approvals



### General Information

|                              |  |
|------------------------------|--|
| Product Name                 | KATM5C                                   |
| Connection Method            | Bolt Connection                          |
| Rating                       | 800 V / 76 A / 16 mm <sup>2</sup> / 2 Nm |
| HSN Number                   | 85389000                                 |
| Standard Packing Qty (in No) | 50                                       |
| Country Of Origin            | India                                    |
| Screw thread                 | M5                                       |

### Dimensions & Weight

|                             |         |           |
|-----------------------------|---------|-----------|
| Width                       | 14.5 mm | 0.57 inch |
| Length                      | 50 mm   | 1.97 inch |
| Height                      | 41.4 mm | 1.63 inch |
| Weight of std. Packing Unit | 1.5 Kg  |           |

### Material Data

|                     |   |
|---------------------|---|
| Insulating Material | Polyamide 6,6                           |
| Standard Colour     | Gray                                    |
| Colour Variants     | Red, Yellow, Blue, Black, Green, Khakhi |

### Rated Conductor Size

|                                      |                     |
|--------------------------------------|---------------------|
| Conductor cross section flexible min | 0.5 mm <sup>2</sup> |
| Conductor cross section flexible max | 16 mm <sup>2</sup>  |
| Conductor cross section solid min    | 0.5 mm <sup>2</sup> |
| Conductor cross section solid max    | 16 mm <sup>2</sup>  |

### Rated Conductor Size

|                                      |                     |
|--------------------------------------|---------------------|
| Conductor cross section flexible min | 0.5 mm <sup>2</sup> |
| Conductor cross section flexible max | 16 mm <sup>2</sup>  |

|                                   |                     |
|-----------------------------------|---------------------|
| Conductor cross section solid min | 0.5 mm <sup>2</sup> |
| Conductor cross section solid max | 16 mm <sup>2</sup>  |

### Ratings - CSA

|  |                  |
|--|------------------|
| CSA Standard                           | CSA C22.2 NO 158 |
| B - CSA Nominal Voltage U <sub>N</sub> | 600 V            |
| B - CSA Nominal Current I <sub>N</sub> | 30 A             |
| B - CSA Wire Min                       | 14 AWG           |
| B - CSA Wire Max                       | 6 AWG            |

### Ratings - UL

|                                       |         |
|---------------------------------------|---------|
| UL Standard                           | UL 1059 |
| B - UL Nominal Voltage U <sub>N</sub> | 600 V   |
| B - UL Nominal Current I <sub>N</sub> | 30 A    |
| B - UL Wire Min                       | 14 AWG  |
| B - UL Wire Max                       | 6 AWG   |

### Product Accessories

| DIN Rail Perforated    |  |   |
|------------------------|--|---|
| CHKDS                  | Height : 15.00 mm<br>Width : 35.00 mm<br>Thickness : 1.50 mm<br>Length : 2,000.00 mm |  |
| CHKS                   | Height : 7.50 mm<br>Width : 35.00 mm<br>Thickness : 1.00 mm                          |  |
| CHS                    | Height : 15.00 mm<br>Width : 32.00 mm<br>Thickness : 1.50 mm                         |  |
| DIN Rail, Unperforated |  |   |
| CHKD                   | Height : 15.00 mm<br>Width : 35.00 mm<br>Thickness : 1.50 mm                         |  |
| CHK                    | Height : 7.50 mm<br>Width : 35.00 mm<br>Thickness : 1.00 mm                          |  |

| <b>End Cap</b>                    |  |   |
|-----------------------------------|--|---|
| CHKENDCAP                         | Height : 14.00 mm<br>Width : 9.00 mm<br>Length : 41.50 mm  |    |
| <b>End Clamp</b>                  |  |   |
| SCUP                              | Height : 34.00 mm<br>Width : 9.00 mm<br>Length : 44.75 mm  |    |
| SCEC35                            | Height : 31.50 mm<br>Width : 8.00 mm<br>Length : 45.80 mm  |    |
| SCUSL                             | Height : 41.10 mm<br>Width : 8.00 mm<br>Length : 47.50 mm  |    |
| SCUDD                             | Height : 50.00 mm<br>Width : 10.00 mm<br>Length : 55.60 mm |   |
| DCKN                              | Height : 33.00 mm<br>Width : 6.00 mm<br>Length : 43.50 mm  |  |
| DCKN10                            | Height : 35.00 mm<br>Width : 10.00 mm<br>Length : 43.50 mm |  |
| SCKN                              | Height : 34.50 mm<br>Width : 8.00 mm<br>Length : 44.90 mm  |  |
| SCUN                              | Height : 35.50 mm<br>Width : 9.50 mm<br>Length : 50.60 mm  |  |
| <b>Marker For Terminal Blocks</b> |  |   |
| LABEL KN10                        | Height : 2.89 mm<br>Width : 10.00 mm<br>Length : 8.50 mm   |  |

| Partition Plate |   |   |
|-----------------|---|---|
| KBXF            | Height : 53.40 mm<br>Width : 1.50 mm<br>Length : 54.00 mm |  |

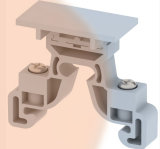
| Marker carriers |  |  |
|-----------------|--|--|
| SCUDDMLH        | Height : 71.50 mm<br>Width : 11.00 mm<br>Length : 55.60 mm |   |
| SCUNMLH         | Height : 53.50 mm<br>Width : 11.00 mm<br>Length : 50.60 mm |   |
| DCKNMLH         | Height : 45.00 mm<br>Width : 10.00 mm<br>Length : 43.50 mm |   |
| SCKNMLH         | Height : 42.00 mm<br>Width : 16.00 mm<br>Length : 44.70 mm |  |

