

## DST2.5-2C2P

Terminal Type - DST2.5-2C2P, Pluggable terminal block, nominal voltage: 500 V, nominal current: 16 A, Rated cross-section - 2.5 mm<sup>2</sup>, connection method: Spring clamp connection, number of connections: 4, cross-section: 0.5 mm<sup>2</sup> - 2.5mm<sup>2</sup>, mounting type: TS 35/7.5, TS 35/15

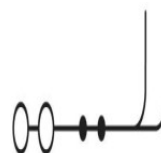

### Approvals

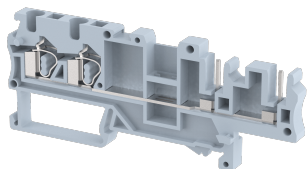

### General Information

Product Name	DST2.5-2C2P
Connection Method	Spring Cage Connection
Rating	500 V / 16 A / 2.5 mm <sup>2</sup>
HSN Number	85389000
Standard Packing Qty (in No)	100
Country Of Origin	India
Screw thread	-

### Dimensions & Weight

Width	5.08 mm	0.2 inch
Length	83 mm	3.27 inch
Height	33 mm	1.3 inch
Weight of std. Packing Unit	1.1 Kg	

### Material Data

Insulating Material	Polyamide 6,6
Standard Colour	Gray
Colour Variants	Red, Yellow, Blue, Black, Green, Khakhi

### Rated Conductor Size

Conductor cross section flexible min	0.5 mm <sup>2</sup>
Conductor cross section flexible max	2.5 mm <sup>2</sup>
Conductor cross section solid min	0.5 mm <sup>2</sup>
Conductor cross section solid max	2.5 mm <sup>2</sup>

### Rated Conductor Size

Conductor cross section flexible min	0.5 mm <sup>2</sup>
Conductor cross section flexible max	2.5 mm <sup>2</sup>

Conductor cross section solid min	0.5 mm <sup>2</sup>
Conductor cross section solid max	2.5 mm <sup>2</sup>

**Product Accessories**

**DIN Rail Perforated**

CHKDS	Height : 15.00 mm Width : 35.00 mm Thickness : 1.50 mm Length : 2,000.00 mm	
CHKS	Height : 7.50 mm Width : 35.00 mm Thickness : 1.00 mm	

**DIN Rail, Unperforated**

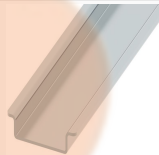
CHKD	Height : 15.00 mm Width : 35.00 mm Thickness : 1.50 mm	
CHK	Height : 7.50 mm Width : 35.00 mm Thickness : 1.00 mm	

**End Clamp**

SCUP	Height : 34.00 mm Length : 44.75 mm	
SCEC35	Height : 31.50 mm Width : 8.00 mm Length : 45.80 mm	
SCUSL	Height : 41.10 mm Width : 8.00 mm Length : 47.50 mm	
SCUDD	Height : 50.00 mm Width : 10.00 mm Length : 55.60 mm	
DCKN	Height : 33.00 mm Width : 6.00 mm Length : 43.50 mm	
DCKN10	Height : 35.00 mm Width : 10.00 mm Length : 43.50 mm	

<b>End Clamp</b>		
SCKN	Height : 34.50 mm Width : 8.00 mm Length : 44.90 mm	
SCUN	Height : 35.50 mm Width : 9.50 mm Length : 50.60 mm	
<b>End Cover</b>		
DSMP2.5-2C2P	Height : 21.50 mm Width : 2.20 mm Length : 83.00 mm	
<b>Marker For Terminal Blocks</b>		
LABEL KN5	Width : 5.00 mm	
<b>Plug-in Bridge/Jumper</b>		
SSL2.5	Height : 22.80 mm Width : 4.85 mm Length : 8.40 mm	
<b>Marker carriers</b>		
SCUDDMLH	Height : 71.50 mm Width : 10.00 mm Length : 55.60 mm	
SCUNMLH	Height : 53.50 mm Width : 9.50 mm Length : 50.60 mm	
DCKNMLH	Height : 45.50 mm Width : 6.00 mm Length : 43.50 mm	
SCKNMLH	Height : 45.50 mm Width : 8.00 mm Length : 44.90 mm	
<b>PLUG</b>		
DST2.5-2C1PP-1W	Height : 26.15 mm Width : 5.08 mm Pitch : 14.45 mm	

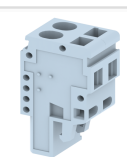
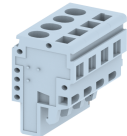
<b>PLUG</b>			
DST2.5-2C1PP-2W	Height : 26.15 mm Width : 10.16 mm Length : 14.45 mm		
DST2.5-2C1PP-4W	Height : 26.15 mm Width : 20.32 mm Length : 14.45 mm		
DST2.5-2C1PP-8W	Height : 26.15 mm Width : 40.64 mm Length : 14.45 mm		