

DST2.5-2C1P

Terminal Type - DST2.5-2C1P, Pluggable terminal block, nominal voltage: 500 V, nominal current: 16 A, Rated cross-section - 2.5 mm², connection method: Spring Cage connection, number of connections: 3, cross-section: 0.5 mm² - 2.5 mm², mounting type: TS 35/7.5, TS 35/15

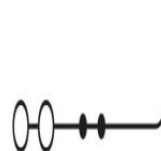

Approvals

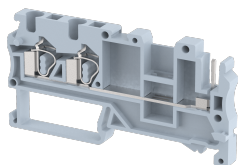

General Information

Product Name	DST2.5-2C1P
Connection Method	Spring Cage Connection
Rating	500 V / 16 A / 2.5 mm ²
HSN Number	85389000
Standard Packing Qty (in No)	100
Country Of Origin	India
Screw thread	NA

Dimensions & Weight

Width	5.08 mm	0.2 inch
Length	66 mm	2.6 inch
Height	33 mm	1.3 inch
Weight of std. Packing Unit	0.86 Kg	

Material Data

Insulating Material	Polyamide 6,6
Standard Colour	Gray
Colour Variants	Red, Yellow, Blue, Black, Green, Khakhi

Rated Conductor Size

Conductor cross section flexible min	0.5 mm ²
Conductor cross section flexible max	2.5 mm ²
Conductor cross section solid min	0.5 mm ²
Conductor cross section solid max	2.5 mm ²

Rated Conductor Size

Conductor cross section flexible min	0.5 mm ²
Conductor cross section flexible max	2.5 mm ²

Conductor cross section solid min	0.5 mm ²
Conductor cross section solid max	2.5 mm ²

Product Accessories

DIN Rail Perforated

CHKDS	Height : 15.00 mm Width : 35.00 mm Thickness : 1.50 mm Length : 2,000.00 mm	
CHKS	Height : 7.50 mm Width : 35.00 mm Thickness : 1.00 mm	

DIN Rail, Unperforated

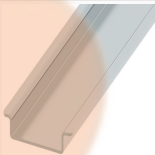
CHKD	Height : 15.00 mm Width : 35.00 mm Thickness : 1.50 mm	
CHK	Height : 7.50 mm Width : 35.00 mm Thickness : 1.00 mm	

End Cap

CHKENDCAP	Height : 14.00 mm Width : 9.00 mm Length : 41.50 mm	
-----------	---	---

End Clamp

SCUP	Height : 34.00 mm Width : 9.00 mm Length : 44.75 mm	
SCEC35	Height : 31.50 mm Width : 8.00 mm Length : 45.80 mm	
SCUSL	Height : 41.10 mm Width : 8.00 mm Length : 47.50 mm	
SCUDD	Height : 50.00 mm Width : 10.00 mm Length : 55.60 mm	

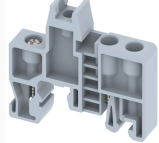
End Clamp		
DCKN	Height : 33.00 mm Width : 6.00 mm Length : 43.50 mm	
DCKN10	Height : 35.00 mm Width : 10.00 mm Length : 43.50 mm	
SCKN	Height : 34.50 mm Width : 8.00 mm Length : 44.90 mm	
SCUN	Height : 35.50 mm Width : 9.50 mm Length : 50.60 mm	

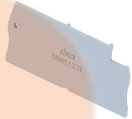
End Cover		
DSMP2.5-2C1P	Height : 21.50 mm Width : 2.20 mm Length : 66.00 mm	

Marker For Terminal Blocks		
LABEL KN5	Height : 2.42 mm Width : 5.00 mm Length : 7.50 mm	

Plug-in Bridge/Jumper		
SSL2.5	Height : 22.80 mm Width : 4.85 mm Pitch : 3.20 mm Length : 8.40 mm	

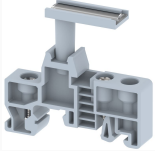
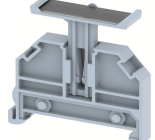
Marker carriers		
SCUDDMLH	Height : 71.50 mm Width : 11.00 mm Length : 55.60 mm	
SCUNMLH	Height : 53.50 mm Width : 11.00 mm Length : 50.60 mm	
DCKNMLH	Height : 45.00 mm Width : 10.00 mm Length : 43.50 mm	

Marker carriers		
SCKNMLH	Height : 42.00 mm Width : 16.00 mm Length : 44.70 mm	

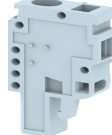
PLUG		
DST2.5-2C1PP-1W	Height : 26.15 mm Width : 5.08 mm Pitch : 14.45 mm	
DST2.5-2C1PP-2W	Height : 26.15 mm Width : 10.16 mm Length : 14.45 mm	
DST2.5-2C1PP-4W	Height : 26.15 mm Width : 20.32 mm Length : 14.45 mm	
DST2.5-2C1PP-8W	Height : 26.15 mm Width : 40.64 mm Length : 14.45 mm	

