

## CBTM6

Terminal Type - CBTM6 , Feed Through Terminal Block , nominal voltage: 1100 V, nominal current: 125 A, Rated cross-section – 35 mm<sup>2</sup>, connection method: Bolt connection - Nut Driver Operated, number of connections: 2, cross section: 6 mm<sup>2</sup> - 35 mm<sup>2</sup>, mounting type : TS32

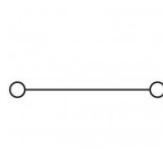

### Approvals

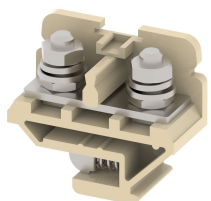

### General Information

Product Name	CBTM6
Connection Method	Bolt Connection
Rating	1100 V / 125 A / 35 mm <sup>2</sup> / 2.5 Nm
HSN Number	85389000
Standard Packing Qty (in No)	25
Country Of Origin	India
Screw thread	M6

### Dimensions & Weight

Width	20 mm	0.79 inch
Length	46 mm	1.81 inch
Height	40 mm	1.57 inch
Weight of std. Packing Unit	0.9 Kg	

### Material Data

Insulating Material	Melamine
Standard Colour	Khakhi
Colour Variants	Red, Yellow, Blue, Black, Green

### Rated Conductor Size

Conductor cross section flexible min	6 mm <sup>2</sup>
Conductor cross section flexible max	35 mm <sup>2</sup>
Conductor cross section solid min	6 mm <sup>2</sup>
Conductor cross section solid max	35 mm <sup>2</sup>

### Rated Conductor Size

Conductor cross section flexible min	6 mm <sup>2</sup>
Conductor cross section flexible max	35 mm <sup>2</sup>

Conductor cross section solid min	6 mm <sup>2</sup>
Conductor cross section solid max	35 mm <sup>2</sup>

**Product Accessories**

Cover Profile		
PCCM40	Width : 40.00 mm Thickness : 1.30 mm Length : 50.60 mm	
PCCM60	Width : 60.00 mm Thickness : 1.30 mm Length : 50.60 mm	
PCC3NV	Width : 300.00 mm Thickness : 1.50 mm Length : 48.50 mm	

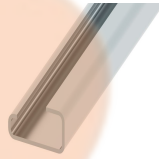
DIN Rail Perforated		
CHS	Height : 15.00 mm Width : 32.00 mm Thickness : 1.50 mm	

End Clamp		
SCS	Height : 26.90 mm Length : 21.00 mm	
SCSN	Height : 31.00 mm Width : 8.40 mm Length : 27.00 mm	
SCUP	Height : 34.00 mm Width : 9.00 mm Length : 44.75 mm	
SCUSL	Height : 41.10 mm Width : 8.00 mm Length : 47.50 mm	
SCUDD	Height : 50.00 mm Width : 10.00 mm Length : 55.60 mm	
SCUN	Height : 35.50 mm Width : 9.50 mm Length : 50.60 mm	

<b>End Cover</b>		
EPS4NV	Height : 28.50 mm Width : 2.50 mm Length : 46.00 mm	
<b>Insertion Bridge</b>		
BSL6-2W	Width : 29.50 mm Pitch : 20.00 mm Length : 29.50 mm	
BSL6-3W	Width : 49.50 mm Pitch : 20.00 mm Length : 29.50 mm	
<b>Marker For Terminal Blocks</b>		
LABEL KN8	Height : 2.43 mm Width : 8.00 mm Length : 8.50 mm	
<b>Partition Plate</b>		
KBZF	Height : 65.00 mm Width : 1.50 mm Length : 65.00 mm	
<b>Marker carriers</b>		
GMC	Height : 48.00 mm Width : 39.00 mm Thickness : 1.00 mm Length : 38.00 mm	
SCUDDMLH	Height : 71.50 mm Width : 11.00 mm Length : 55.60 mm	
SCUNMLH	Height : 53.50 mm Width : 11.00 mm Length : 50.60 mm	