

## CATM5

Terminal Type - CATM5, Stud Type terminal block, nominal voltage: 1100 V, nominal current: 76 A, Rated cross-section - 16 mm<sup>2</sup>, connection method: Bolt Connection - Screwdriver operated, number of connections: 2, cross-section: 2.5 mm<sup>2</sup> - 16 mm<sup>2</sup>, mounting type : TS32

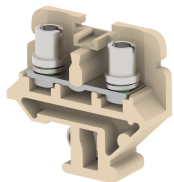

### Approvals



### General Information

Product Name	CATM5
Connection Method	Bolt Connection
Rating	1100 V / 76 A / 16 mm <sup>2</sup> / 2 Nm
HSN Number	85389000
Standard Packing Qty (in No)	50
Country Of Origin	India
Screw thread	M5

### Dimensions & Weight

Width	13 mm	0.51 inch
Length	46 mm	1.81 inch
Height	42 mm	1.65 inch
Weight of std. Packing Unit	1.42 Kg	

### Material Data

Insulating Material	Melamine
Standard Colour	Khakhi
Colour Variants	Red, Yellow, Blue, Black

### Rated Conductor Size

Conductor cross section flexible min	2.5 mm <sup>2</sup>
Conductor cross section flexible max	16 mm <sup>2</sup>
Conductor cross section solid min	2.5 mm <sup>2</sup>
Conductor cross section solid max	16 mm <sup>2</sup>

### Rated Conductor Size

Conductor cross section flexible min	2.5 mm <sup>2</sup>
Conductor cross section flexible max	16 mm <sup>2</sup>

Conductor cross section solid min	2.5 mm <sup>2</sup>
Conductor cross section solid max	16 mm <sup>2</sup>

**Product Accessories**

<b>Cover Profile</b>		
PCC3NV	Width : 300.00 mm Thickness : 1.50 mm Length : 48.50 mm	
PCCM26NV	Width : 26.00 mm Thickness : 1.00 mm Length : 45.50 mm	
PCCM39	Width : 39.00 mm Thickness : 1.00 mm Length : 45.50 mm	
<b>DIN Rail Perforated</b>		
CHS	Height : 15.00 mm Width : 32.00 mm Thickness : 1.50 mm	
<b>End Clamp</b>		
SCS	Height : 26.90 mm Length : 21.00 mm	
SCSN	Height : 31.00 mm Width : 8.40 mm Length : 27.00 mm	
SCUP	Height : 34.00 mm Width : 9.00 mm Length : 44.75 mm	
SCUSL	Height : 41.10 mm Width : 8.00 mm Length : 47.50 mm	
SCUDD	Height : 50.00 mm Width : 10.00 mm Length : 55.60 mm	
SCUN	Height : 35.50 mm Width : 9.50 mm Length : 50.60 mm	

<b>End Cover</b>		
EPS4NV	Height : 28.50 mm Width : 2.50 mm Length : 46.00 mm	
<b>Insertion Bridge</b>		
ADSL-10W	Width : 124.50 mm Pitch : 13.00 mm Length : 24.00 mm	
ADSL-2W	Width : 20.50 mm Pitch : 13.00 mm Length : 24.00 mm	
ADSL-3W	Width : 33.50 mm Pitch : 13.00 mm Length : 24.00 mm	
ADSL-4W	Width : 46.50 mm Pitch : 13.00 mm Length : 24.00 mm	
ADSL-7W	Width : 85.50 mm Pitch : 13.00 mm Length : 24.00 mm	
<b>Marker For Terminal Blocks</b>		
LABEL KN8	Height : 2.43 mm Width : 8.00 mm Length : 8.50 mm	
<b>Partition Plate</b>		
KBZF	Height : 65.00 mm Width : 1.50 mm Length : 65.00 mm	
<b>Marker carriers</b>		
GMC	Height : 48.00 mm Width : 39.00 mm Thickness : 1.00 mm Length : 38.00 mm	
SCUDDMLH	Height : 71.50 mm Width : 11.00 mm Length : 55.60 mm	

**Marker carriers**

SCUNMLH	Height : 53.50 mm Width : 11.00 mm Length : 50.60 mm	
---------	------------------------------------------------------------	-------------------------------------------------------------------------------------

