

## CATM4

Terminal Type - CATM4 , Feed Through Terminal Block , nominal voltage: 1100 V, nominal current: 57 A, Rated cross-section - 10 mm<sup>2</sup>, connection method: Bolt Connection - Screw driver operated , number of connections: 2, cross-section: 2.5 mm<sup>2</sup> - 10 mm<sup>2</sup> , mounting type : TS32

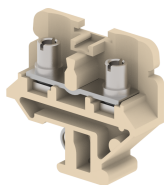

### Approvals



### General Information

|                              |   |
|------------------------------|---|
| Product Name                 | CATM4                                       |
| Connection Method            | Bolt Connection                             |
| Rating                       | 1100 V / 57 A / 10 mm <sup>2</sup> / 1.2 Nm |
| HSN Number                   | 85389000                                    |
| Standard Packing Qty (in No) | 50  |
| Country Of Origin            | India                                       |
| Screw thread                 | M4  |

### Dimensions & Weight

|                             |         |           |
|-----------------------------|---------|-----------|
| Width                       | 13 mm   | 0.51 inch |
| Length                      | 46 mm   | 1.81 inch |
| Height                      | 42 mm   | 1.65 inch |
| Weight of std. Packing Unit | 1.26 Kg |           |

### Material Data

|                     |                                 |
|---------------------|---------------------------------|
| Insulating Material | Melamine                        |
| Standard Colour     | Khakhi                          |
| Colour Variants     | Red, Yellow, Blue, Black, Green |

### Rated Conductor Size

|                                      |                     |
|--------------------------------------|---------------------|
| Conductor cross section flexible min | 2.5 mm <sup>2</sup> |
| Conductor cross section flexible max | 6 mm <sup>2</sup>   |
| Conductor cross section solid min    | 2.5 mm <sup>2</sup> |
| Conductor cross section solid max    | 6 mm <sup>2</sup>   |

### Rated Conductor Size

|                                      |                     |
|--------------------------------------|---------------------|
| Conductor cross section flexible min | 2.5 mm <sup>2</sup> |
| Conductor cross section flexible max | 6 mm <sup>2</sup>   |

|                                   |                     |
|-----------------------------------|---------------------|
| Conductor cross section solid min | 2.5 mm <sup>2</sup> |
| Conductor cross section solid max | 6 mm <sup>2</sup>   |

**Product Accessories**

| <b>Cover Profile</b>       |   |   |
|----------------------------|---|---|
| PCC3NV                     | Width : 300.00 mm<br>Thickness : 1.50 mm<br>Length : 48.50 mm |    |
| PCCM26NV                   | Width : 26.00 mm<br>Thickness : 1.00 mm<br>Length : 45.50 mm  |    |
| PCCM39                     | Width : 39.00 mm<br>Thickness : 1.00 mm<br>Length : 45.50 mm  |    |
| <b>DIN Rail Perforated</b> |   |   |
| CHS                        | Height : 15.00 mm<br>Width : 32.00 mm<br>Thickness : 1.50 mm  |   |
| <b>End Clamp</b>           |   |   |
| SCS                        | Height : 26.90 mm<br>Length : 21.00 mm                        |  |
| SCSN                       | Height : 31.00 mm<br>Width : 8.40 mm<br>Length : 27.00 mm     |  |
| SCUP                       | Height : 34.00 mm<br>Width : 9.00 mm<br>Length : 44.75 mm     |  |
| SCUSL                      | Height : 41.10 mm<br>Width : 8.00 mm<br>Length : 47.50 mm     |  |
| SCUDD                      | Height : 50.00 mm<br>Width : 10.00 mm<br>Length : 55.60 mm    |  |
| SCUN                       | Height : 35.50 mm<br>Width : 9.50 mm<br>Length : 50.60 mm     |  |

| <b>End Cover</b>                  |   |   |
|-----------------------------------|---|---|
| EPS4NV                            | Height : 28.50 mm<br>Width : 2.50 mm<br>Length : 46.00 mm                         |    |
| <b>Insertion Bridge</b>           |   |   |
| ADSL-2W                           | Width : 20.50 mm<br>Pitch : 13.00 mm<br>Length : 24.00 mm                         |    |
| ADSL-10W                          | Width : 124.50 mm<br>Pitch : 13.00 mm<br>Length : 24.00 mm                        |    |
| ADSL-3W                           | Width : 33.50 mm<br>Pitch : 13.00 mm<br>Length : 24.00 mm                         |    |
| ADSL-4W                           | Width : 46.50 mm<br>Pitch : 13.00 mm<br>Length : 24.00 mm                         |   |
| ADSL-7W                           | Width : 85.50 mm<br>Pitch : 13.00 mm<br>Length : 24.00 mm                         |  |
| <b>Marker For Terminal Blocks</b> |   |   |
| LABEL KN8                         | Height : 2.43 mm<br>Width : 8.00 mm<br>Length : 8.50 mm                           |  |
| <b>Partition Plate</b>            |   |   |
| KBZF                              | Height : 65.00 mm<br>Width : 1.50 mm<br>Length : 65.00 mm                         |  |
| <b>Marker carriers</b>            |   |   |
| GMC                               | Height : 48.00 mm<br>Width : 39.00 mm<br>Thickness : 1.00 mm<br>Length : 38.00 mm |  |
| SCUDDMLH                          | Height : 71.50 mm<br>Width : 11.00 mm<br>Length : 55.60 mm                        |  |

**Marker carriers**

|         |  |   |
|---------|--|---|
| SCUNMLH | Height : 53.50 mm<br>Width : 11.00 mm<br>Length : 50.60 mm |  |
|---------|--|---|

